



HITCH, 2" Receiver, 2016-2023 Toyota Tacoma

INSTALLATION INSTRUCTIONS

READ ALL WARNINGS AND INSTRUCTIONS THOROUGHLY BEFORE INSTALLATION

⚠ WARNING: The manufacturer of your vehicle may specify towing capacities lower than the capacities noted below. Never exceed the vehicle manufacturer's recommended towing capacity. Consult your vehicle's owner's manual for the manufacturer's recommended towing capacity for your specific vehicle.

⚠ WARNING: Failure to adhere to the exact torque specifications noted in these installation instructions can result in property damage and/or bodily injury. Failure to follow all specifications and instructions will void the hitch warranty.

NOTICE:

Always use proper tools and safety equipment to ensure a safe and quality installation. Inspection of the trailer hitch should be performed before and after each use to ensure all mounting hardware is tight and related hitch components are secure.

LEVEL OF DIFFICULTY: Easy

Installation difficulty levels are based on the time and effort required. They will vary depending on the installer's expertise. Vehicle condition could be a factor in the level of difficulty for a proper installation.

WEIGHT CARRYING CAPACITY	
Gross Trailer Weight (GTWR)	6,000 LBS
Tongue Weight (TW)	900 LBS

WEIGHT DISTRIBUTING CAPACITY	
Gross Trailer Weight (GTWR)	8,000 LBS
Tongue Weight (TW)	900 LBS

TOOLS REQUIRED			
SAFETY GLASSES	TORQUE WRENCH	RATCHET	19mm SOCKET
3/4" SOCKET	10" SOCKET EXTENSION		

INSTALLATION:

1. Locate the two mounting holes in the bottom face of the rear bumper beam as well as the two open ends of the beam that will be used as hardware access holes.
2. Using the standard fishwire technique, Detail A of the illustration, install a 1/2-13 UNC carriage bolt (**ITEM 3**) and a 1/2" square hole spacers (**ITEM 4**) into each of the two mounting holes on the rear bumper beam, leaving the fishwires attached to the carriage bolts. See Detail B of the illustration with specific tips for bolt installation.
3. Locate the four hardware mounting holes in the bottom face of the rear frame rails, two hole in each rail. Lift hitch into position while feeding the fishwires through their respective mounting holes on the hitch as shown in the illustration.
4. Secure hitch to the vehicle's frame rails with the M12 hex head bolts (**ITEM 1**) and 1/2" conical toothed washers (**ITEM 2**).
5. Sequentially, remove each fishwire and carefully thread a 1/2-13 UNC flanged hex nut (**ITEM 5**) onto the protruding 1/2-13 carriage bolt, being careful not to push the bolt inside the bumper beam in the process.
6. **TORQUE ALL M12 FASTENERS TO 86 FT-LB AND 1/2-13 UNC FASTENERS TO 110 FT-LB.**

See next page for illustrations

ITEM	DESCRIPTION	QTY
1	M12 x 1.25; 40 HEX HEAD BOLT, CL10.9	4
2	1/2" CONICAL TOOTHED WASHER	4
3	1/2-13 UNC x 1-3/4" CARRIAGE BOLT, GR8	2
4	1/4" x 1-1/4" x 3" SQUARE HOLE SPACER	2
5	1/2-13 UNC SERRATED FLANGE HEX NUT	2
6	1/2" X 30" FISHWIRE	2

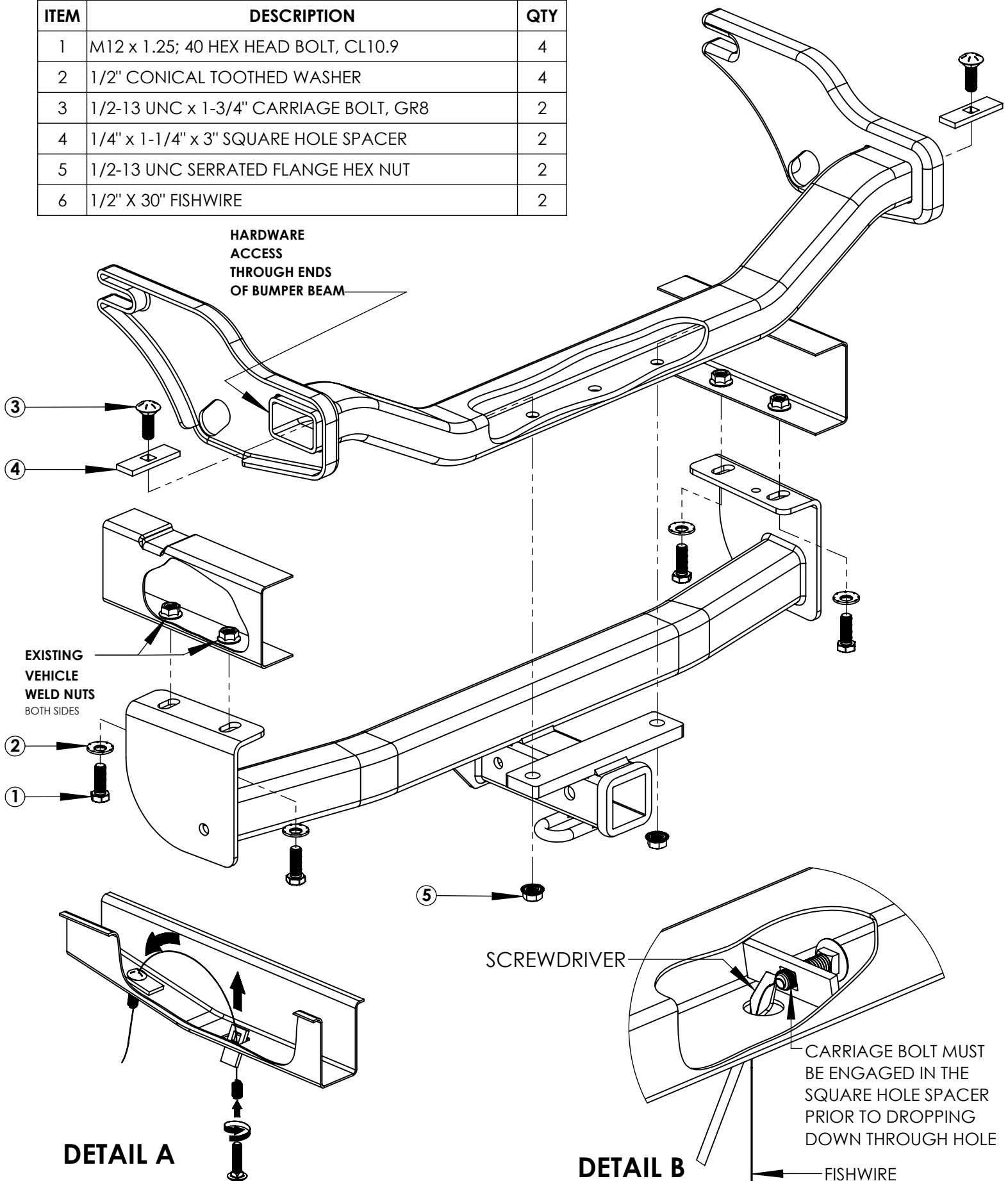

TOWSMART CUSTOM LLC
 30339 Diamond Parkway
 Cleveland, Ohio 44139
 1-844-295-9215
 Rev. B - 20260415