



## HITCH, 2" Receiver, Ram 1500 (With OEM Class III Towing Bumper) INSTALLATION INSTRUCTIONS

### READ ALL WARNINGS AND INSTRUCTIONS THOROUGHLY BEFORE INSTALLATION

**⚠ WARNING:** The manufacturer of your vehicle may specify towing capacities lower than the capacities noted below. Never exceed the vehicle manufacturer's recommended towing capacity. Consult your vehicle's owner's manual for the manufacturer's recommended towing capacity for your specific vehicle.

**⚠ WARNING:** Failure to adhere to the exact torque specifications noted in these installation instructions can result in property damage and/or bodily injury. Failure to follow all specifications and instructions will void the hitch warranty.

### NOTICE:

Always use proper tools and safety equipment to ensure a safe and quality installation. Inspection of the trailer hitch should be performed before and after each use to ensure all mounting hardware is tight and related hitch components are secure.

**LEVEL OF DIFFICULTY:** Easy - Installation difficulty levels are based on the time and effort required. They will vary depending on the installer's expertise. Vehicle condition could be a factor in the level of difficulty for a proper installation.

WEIGHT CARRYING CAPACITY	
Gross Trailer Weight (GTWR)	6,000 LBS
Tongue Weight (TW)	600 LBS

WEIGHT DISTRIBUTING CAPACITY
THIS HITCH IS NOT RATED FOR USE AS A WEIGHT DISTRIBUTING HITCH.

TOOLS REQUIRED			
TORQUE WRENCH	RATCHET	3/4" SOCKET	1/2" HEX BIT SOCKET

### INSTALLATION:

1. Open hardware pack. Using the fasteners provided, chase the threads on both the nut plate and the receiver tube assembly.
2. Remove the circular cover on the OEM step bumper, directly behind the rear license plate. Retain for reassembly.
3. Locate the safety chain anchor points of the OEM hitch frame shown in the illustration. Place the nut plate **(ITEM 4)** on top of these anchor points while making sure the weld nuts of the nut plate are positioned on top.
4. Assemble the 3/4" flat head screw **(ITEM 1)** into the hole of the OEM step bumper where the circular cover was removed, allowing it to drop down through the OEM hitch frame.
5. Lift hitch into position and loosely secure with the 3/4" flat head screw **(ITEM 1)**. Install the two 1/2" conical toothed washers **(ITEM 2)** onto the 1/2" hex head screws **(ITEM 3)** making sure that the washer's teeth face away from the head of the screw. Thread the 1/2" screw up through the hitch, through the OEM hitch frame and into the two weld nuts of the nut plate. The teeth of the conical toothed washers should be mated with the hitch's mounting flange.

6. Tighten all three fasteners, starting with the 3/4" flat head screw to allow it to seat properly into the hole of the OEM hitch frame. **Torque the 1/2-13 UNC fasteners to 75 ft-lb and the 3/4-10 UNC fastener to 250 ft-lb** with a properly calibrated torque wrench.

7. Reinstall the circular cap into the OEM step bumper.

ITEM	DESCRIPTION	QTY
1	Flat Head Screw, 3/4-10 x 3-1/4; GR8	1
2	Conical Toothed Washer, 1/2"	2
3	Hex Head Screw, 1/2-13 UNC x 1-1/2", GR8	2
4	Nut Plate	1

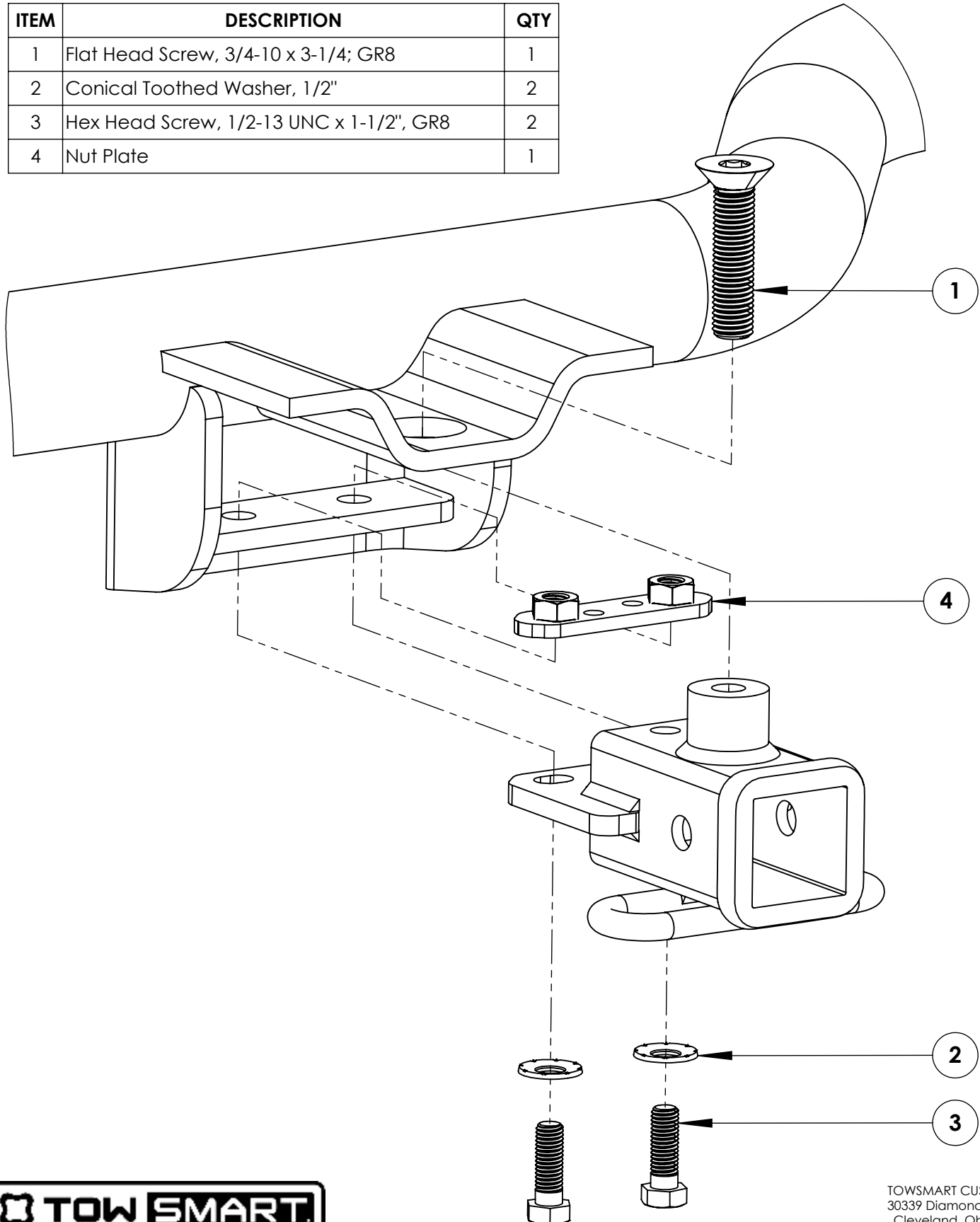

TOWSMART CUSTOM LLC  
 30339 Diamond Parkway  
 Cleveland, Ohio 44139  
 1-844-295-9215